

# EPS PRODUCT

- Expanded Polystyrene (EPS) panel with customized Galvanized wire mesh—produced in factory
- An industrialized building system (IBS) utilizing factory manufactured light weight panel for building construction

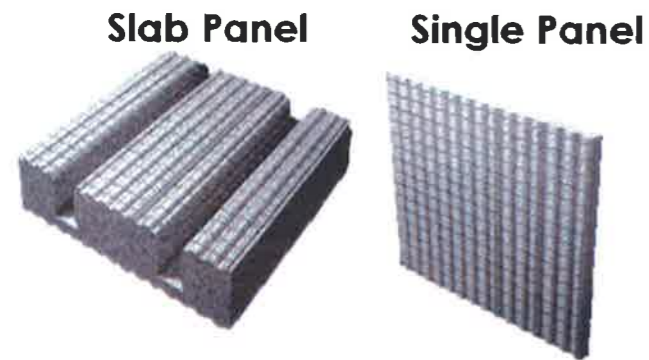

PSM # 25- S.S DENSITY 15 kg/m <sup>3</sup>	EPS THICKNESS (MM)	CONCRETE THICKNESS (MM)	DISTANCE BETWEEN THE TWO	TOTAL THICKNESS (MM)	PANEL WEIGHT (KG/M <sup>2</sup> )	WALL WEIGHT (PANEL +CONCRETE) (KG/M <sup>2</sup> )
PSM40	40	35	62.5	110	3.54	146.5
PSM50	50	35	72.5	120	3.73	146.7
PSM60	60	35	82.5	130	3.93	147.0
PSM80	80	35	102.5	150	4.32	147.4
PSM100	100	35	122.5	170	4.71	147.9
PSM120	120	35	142.5	190	5.10	148.4
PSM140	140	35	162.5	210	5.49	148.9
PSM160	160	35	182.5	230	5.88	149.4
PSM180	180	35	202.5	250	6.27	149.9
PSM200	200	35	222.5	270	6.66	150.3

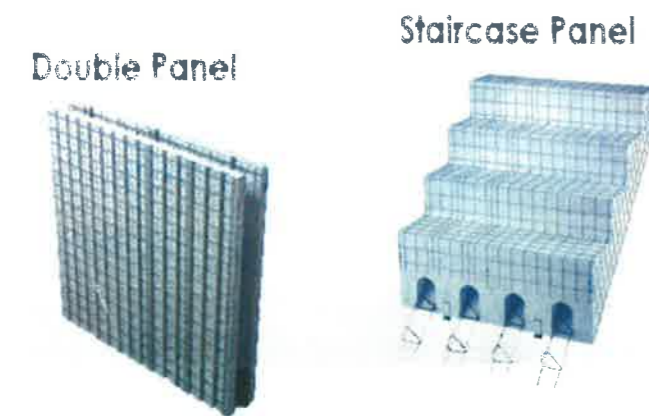

# INSULATED HOME

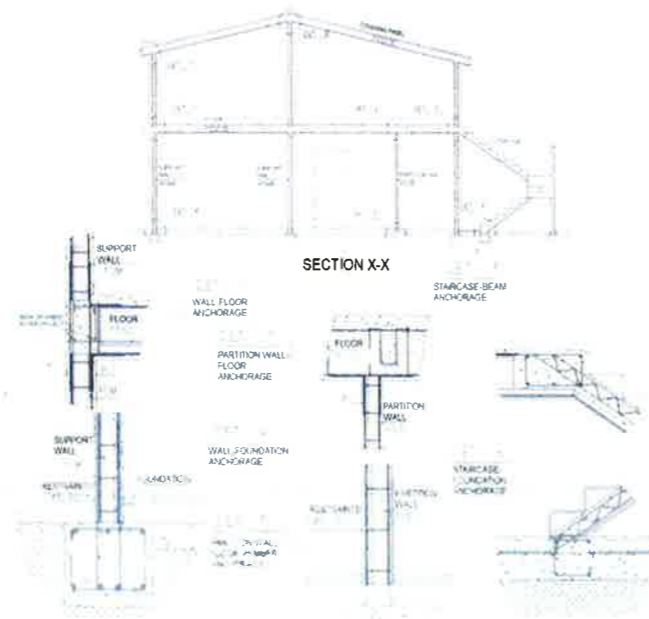

Lot 11115, Kampong Sy Rasau,  
Batu 8, Pulau Meranti,  
47120 Puchong, Selangor,  
Phone: +603-803-80611857  
Fax: +603-80609841  
E-mail: insafoam@insafoam.com.my



# EVERYONE CAN AFFORD TO OWN A INSULATED HOME

INSAFOAM IM2 system is the solution for rapidly constructible, economical, sustainable and energy efficient building

## COMPANY PROFILE

**INSAFOAM INSULATION (Malaysia) Sdn Bhd**, a wholly owned Malaysian company, was incorporated on September 8, 1992. Insafoam manufactures and distributes its branded **INSAPIPE** range of polyurethane pre-insulated pipes in Malaysia, the South-East Asia region and for the Middle East region. After past over the year, now Insafoam expanding business in *Industrialized Building System (IBS)* and subsidiaries company under Insafoam are known as **INSAFOAM INSULATION(N) SDN BHD** as manufacturer and **INSAFOAM IM2 SYSTEM SDN BHD** as marketing company.

**INSAFOAM SYSTEM SDN BHD** adopts IM2 from Italian technology as main products. For over 30 years, our associated Italian company as aspired has designing and developing the technology to produce building system components, marketing worldwide turnkey systems and assisting its customers during the manufacturing, design and installation phases.

### OUR VISION

The company aims to become the leader in the industry and the region and to increase its international market. We embrace the philosophy that a satisfied customer is a repeat customer.

### OUR MISSION

- To offer people from all over the country the opportunity to build a safe house, in a short time, guaranteeing the highest levels of comfortable living and considerable energy saving without forgoing design and the wide range of finishes.
- We are not alone a builder and supplier but to offer everyone can afford to own an insulated home.

## WHAT IS EPS?

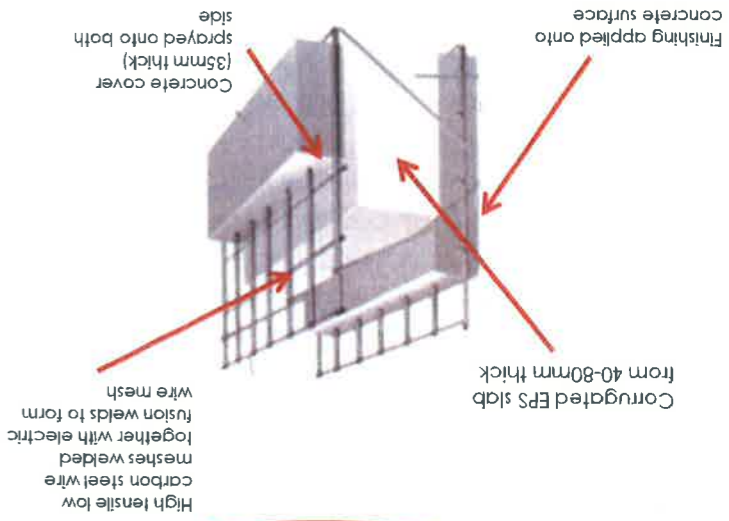

ITEM	Description	Insafom IM2	Conventl	Precast Panels
1	Light weight structure	0.75	1	1.3
2	Time & cost saving	0.75 & 0.85	1	0.9
3	Earth Quake Resistance (RS)	9	4	4
4	Thermal Insulation	1.25	1.0	1.0
5	Sound Insulation (STC)	38	28	30

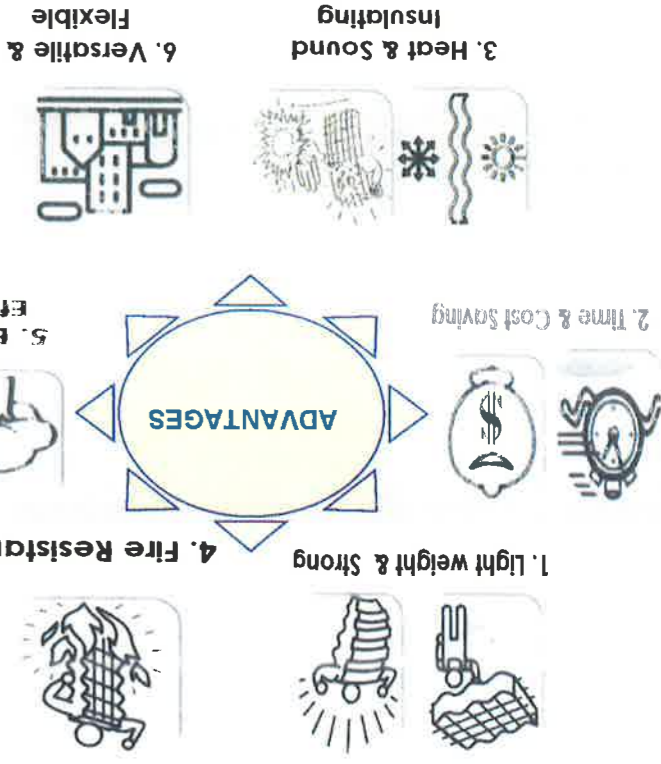

## TEST & APPROVALS (Malaysia)



## PANEL INSTALLATION

✓ The insafom IM2 panel remarkable lightness allows easy and quick transport and handling

✓ The insafom IM2 panel can be manually positioned and linked together by a nail gun or conventional



Single panel for floor and roofing



The placement of service pipes (electricity, water, gas), is carried out quickly and easily, behind the wire mesh.



Spraying of the coating layer on the panel using the plaster sprayer

## LABORATORY TESTING OF PANEL

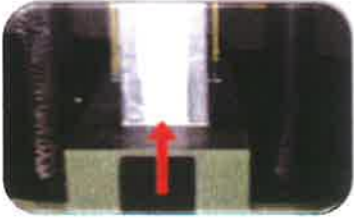

1. Centred Compression

-Maximum loading = 707 KN/m

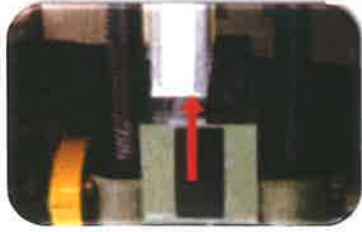

2. Eccentric compression



3. Simple flexion

70mm single panel (comp.layer 30mm) — Maximum loading = 12.2KN/m

## SIMILAR REFERENCE PRODUCT

